

SurfaceCool™ Wet - Waterproofing

Description

SurfaceCool™ Wet is designed for any wet area under tiling which will be in direct contact and reputable using of water such as water tanks, kitchen, bathroom, and others in residential or commercial buildings in either on a new building or for repairing old ones. In both cases, a waterproofing system needs to be applied under tiling (The Wet Area) in order to protect the concrete /steel and prevent any water leakage.

SurfaceCool™ Wet is designed for Wet Areas is a Water-based, 100 % acrylic polymer emulsion designed for waterborne coating applications and it is used mainly in a wet area, this technology solutions (GO Green) and guidance on the indoor and outdoor installation of composite waterproofing systems with tile finish such as water tanks , Bathrooms, Swimming poolsetc .

SurfaceCool™ Wet waterproofing and deck coating systems combine ease of use, fast installation and durable performance. Quick cure times allow treated decks to be returned to service within a few hours of completion.

The joints in a tile covering should be regarded with SurfaceCool JTW™ system which prevents migration of moisture into a dry area.

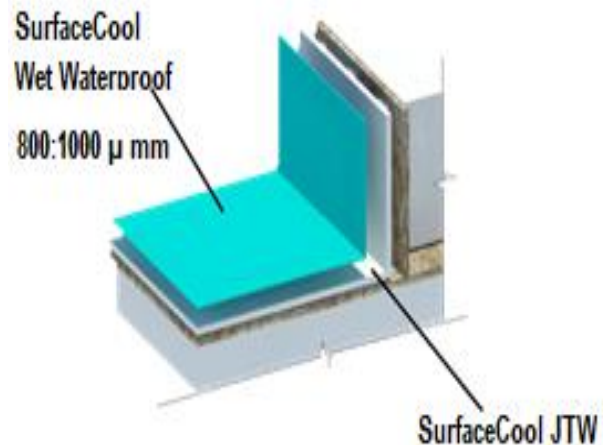

SurfaceCool™ Wet offers owners and designers long-term concrete protection against traffic and the elements, all of this is backed by SurfaceCool materials with an extended warranty program for 10 years.



Area of applications:

SurfaceCool™ Wet offering a complete high-performance solution for the creation of interior and exterior weather are designed for wet area inside or outside the buildings:

- Bathrooms • Car parks • Concrete roofs
- Concrete water tanks • GRP tanks • Swimming pools • Foundations and underground works
- Electrical and Mechanical Rooms • Common access walkways • Balconies.

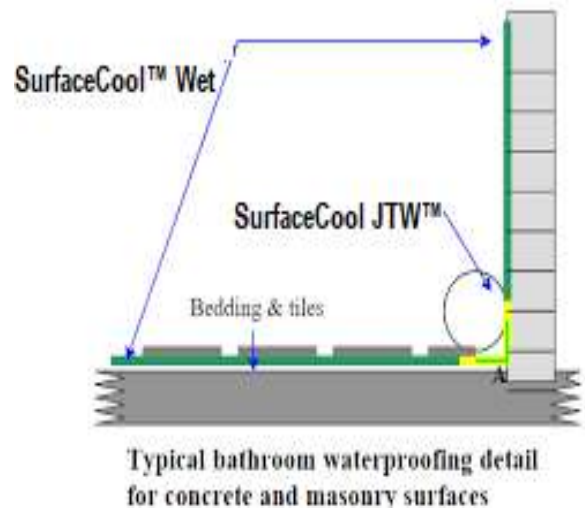
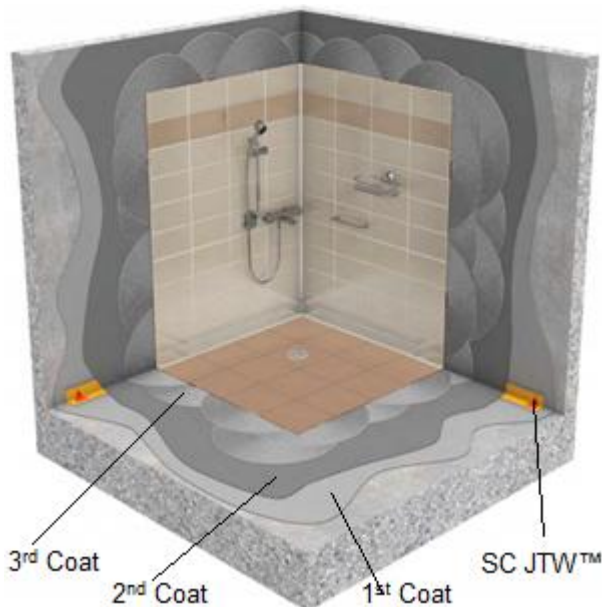

SurfaceCool™ Wet waterproofing and surfacing systems offer a range of features and benefits its including:

- Excellent adhesion a variety of substrates such as concrete, metal and asphaltic surfaces.
- Up to 10 years manufacturer's labor and materials warranty.
- Improved washability
- Enhanced film formation
- Greater durability with thickness up to 1000 μ DFT .
- Faster application - it will be trafficked within 45 minutes, even at low temperatures Formulated without solvents.
- Formulated without solvents.

Appearance: Liquid
 Colour : White

Typical Properties

Active Ingredients: 83.60%
 Density at 20 C° 0.93 kg/Litre
 VOCS <0.1gr/L (DCL)
 Heavy Metals None (DCL)
 Fire Resistance Class A (ASTM E84)
 Max. Tensile Strength: 0.85 (MPa)
 Average Elongation: 143%
 Water Vapor Permeance: 23.1 Perms
 Variable Permeability: Breath water vapor when dry and water migration when saturated
 Break Stress: 109 psi
 Flammability: Non-flammable

Properties

One-compound liquid-applied for:

- Concrete roofs / Walls
- Metal roofs
- Composite roofs (GRP, etc)

Application

Airless sprayer or roller Surfaces must be free of dust, laitance, grease and any other contaminant that may affect adhesion. Use of high water or air pressure is recommended as a rule

Storage / Packing

Store at minimum 0 Deg C - maximum 30 Deg C (Do NOT FREEZE) , 18.93 Liters.